

Pedestrian Environment and Traffic Improvements to Bring Vibrancy to the Wong Chuk Hang, Aberdeen Waterfront and Ap Lei Chau North Areas – Feasibility Study

為黃竹坑、香港仔海濱及鴨脷洲北地區增添活力的行人環境及交通改善 – 可行性研究



Base Plan: Conceptual Master Plan 2.0
底圖: 概念總綱計劃 2.0

--- Study Area
研究範圍

Enhance Connectivity and Walkability 加強連繫及易行

Formulate and implement schemes to improve the pedestrian environment and vehicular traffic to bring vibrancy
制定和實施改善行人環境及行車交通措施，以增添活力



Improve Urban Environment 改善城市環境

Enhance public spaces through “place-making”, connect these spaces to form an integrated network, and promote green urban environment
以「地方營造」手法改善公共空間，把它們連成一個綜合網絡，並促進綠色城市環境

Unleash Development Potential 釋放發展潛力

Unleash development potential through promoting optimal use of land and facilitating development/redevelopment projects
促進善用土地及利便發展或重建項目，以釋放發展潛力



Enliven the District 激發地區活力

Provide an appealing and vibrant place for people to work, live and enjoy
提供一個具吸引力和充滿活力的地方，讓大家工作、生活和玩樂

Pedestrian-Friendly Blue-Green Interlink Framework 行人友善、藍綠互融框架 3

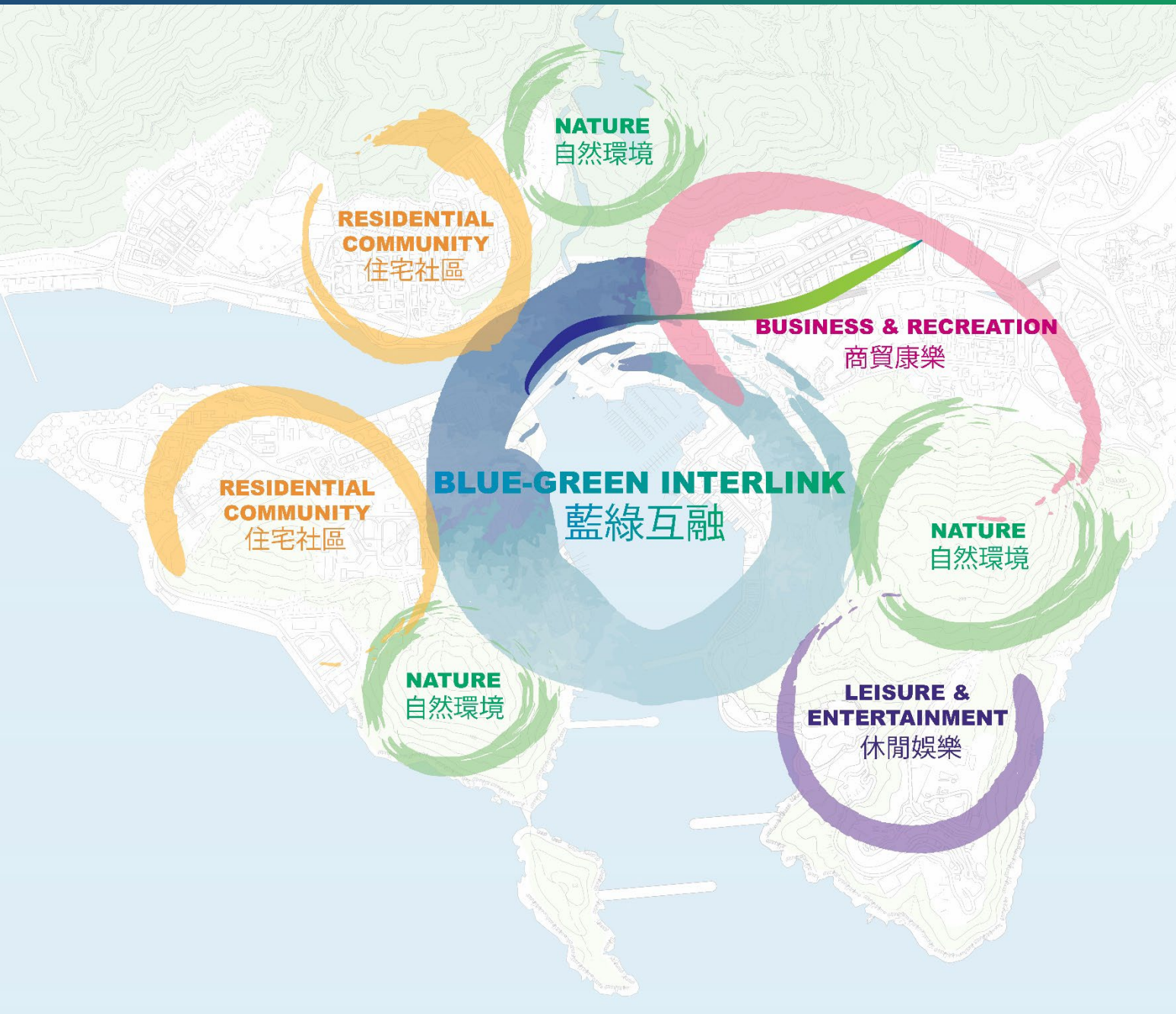

Aims 目的

- Establish interconnected public realm with integration of blue-green features to enhance connectivity and walkability
建立互相連繫的公共空間網絡，糅合藍綠自然景色，提升連繫性和易行度
- Improve pedestrian safety and traffic circulation
改善行人安全和交通流通
- Enhance public open spaces and the waterfront areas
優化公共休憩空間和海濱地帶
- Support existing and planned developments
支持現有和計劃的發展項目
- Reinforce district identity
加強地區特色

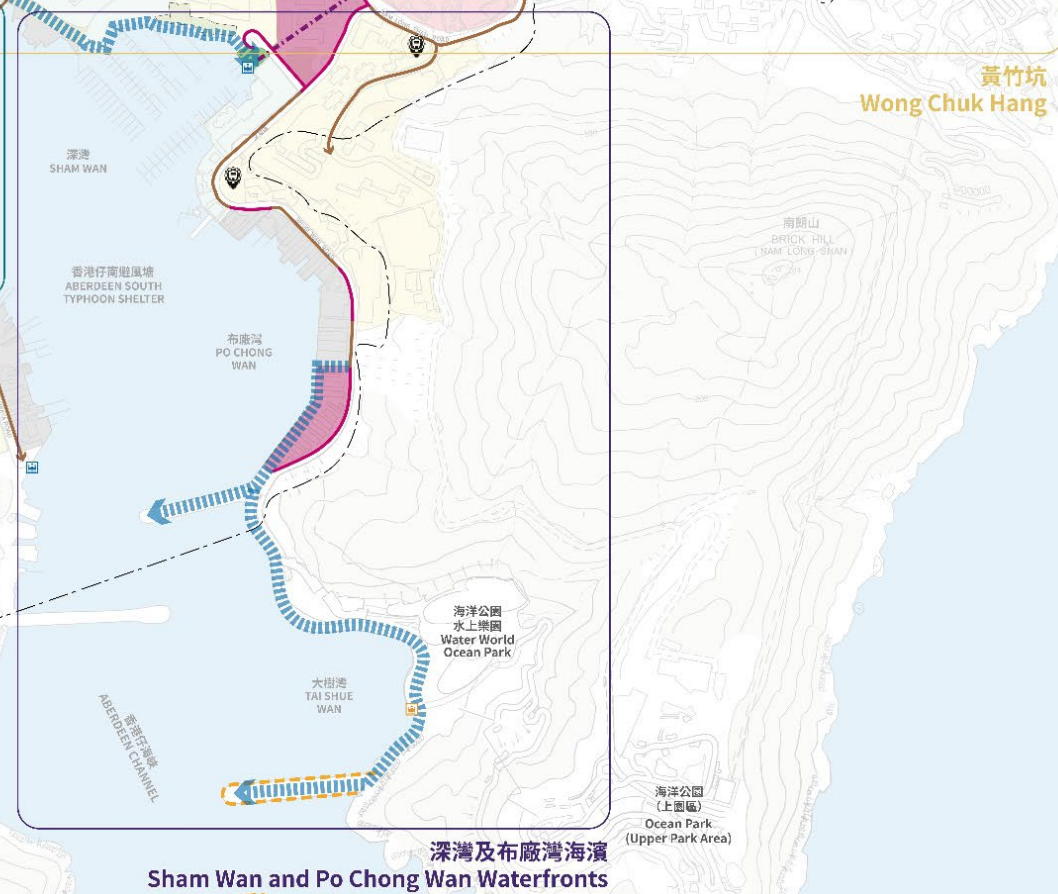
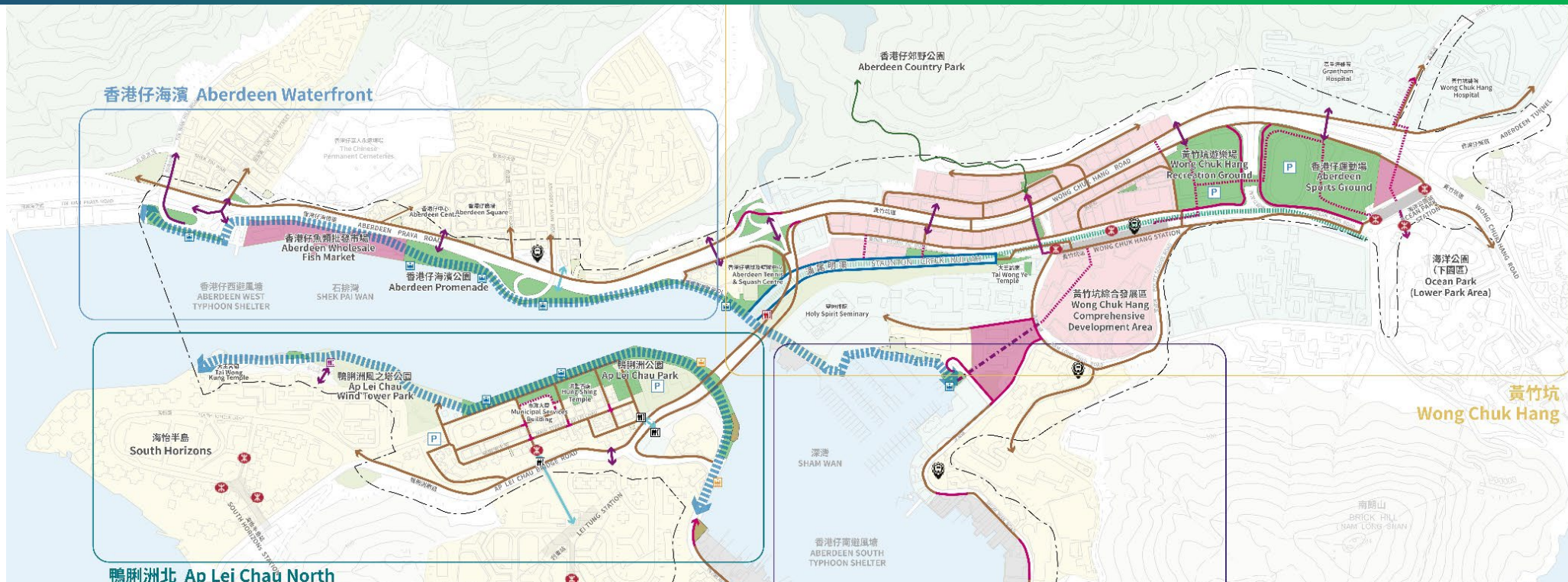

Pedestrian Environment and Traffic Improvement Proposals

行人環境和交通改善方案

Short-term Proposals 短期方案

圖例 LEGEND

- 主要行人路 Major Pedestrian Footpath
- 現有天橋/行人隧道 Existing Footbridge/Subway
- 提供行人連接 Pedestrian Link Provision
- 公共運輸交匯處 Public Transport Interchange
- 登岸設施/碼頭 Landing Facility/Pier
- 現有休憩用地 Existing Open Space
- 短期改善方案 Short Term Enhancement Schemes



c. Pedestrian Crossing at Aberdeen Main Road near Jadewater
 香港仔大道近南灣御園的行人過路處

d. Improvements to Aberdeen Bus Terminus
 改善香港仔巴士總站

e. Improvement at Kwun Hoi Path
 改善觀海徑

香港仔西避風塘
 ABERDEEN WEST
 TYPHOON SHELTER

石排灣
 SHEK PAI WAN

c. Pedestrian Crossing at Aberdeen Main Road near Jadewater 香港仔大道近南灣御園的行人過路處

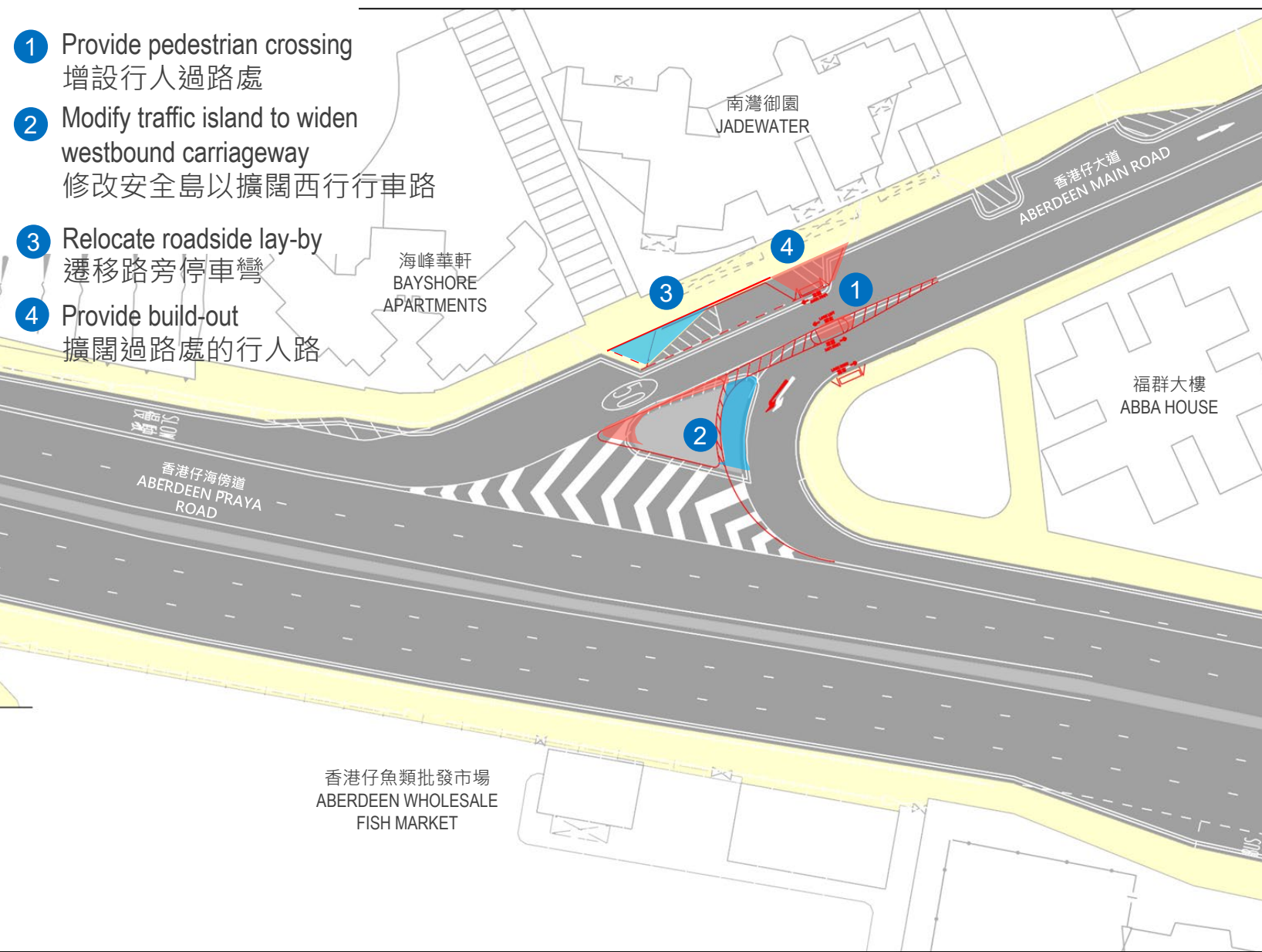

d. Improvements to Aberdeen Bus Terminus 改善香港仔巴士總站

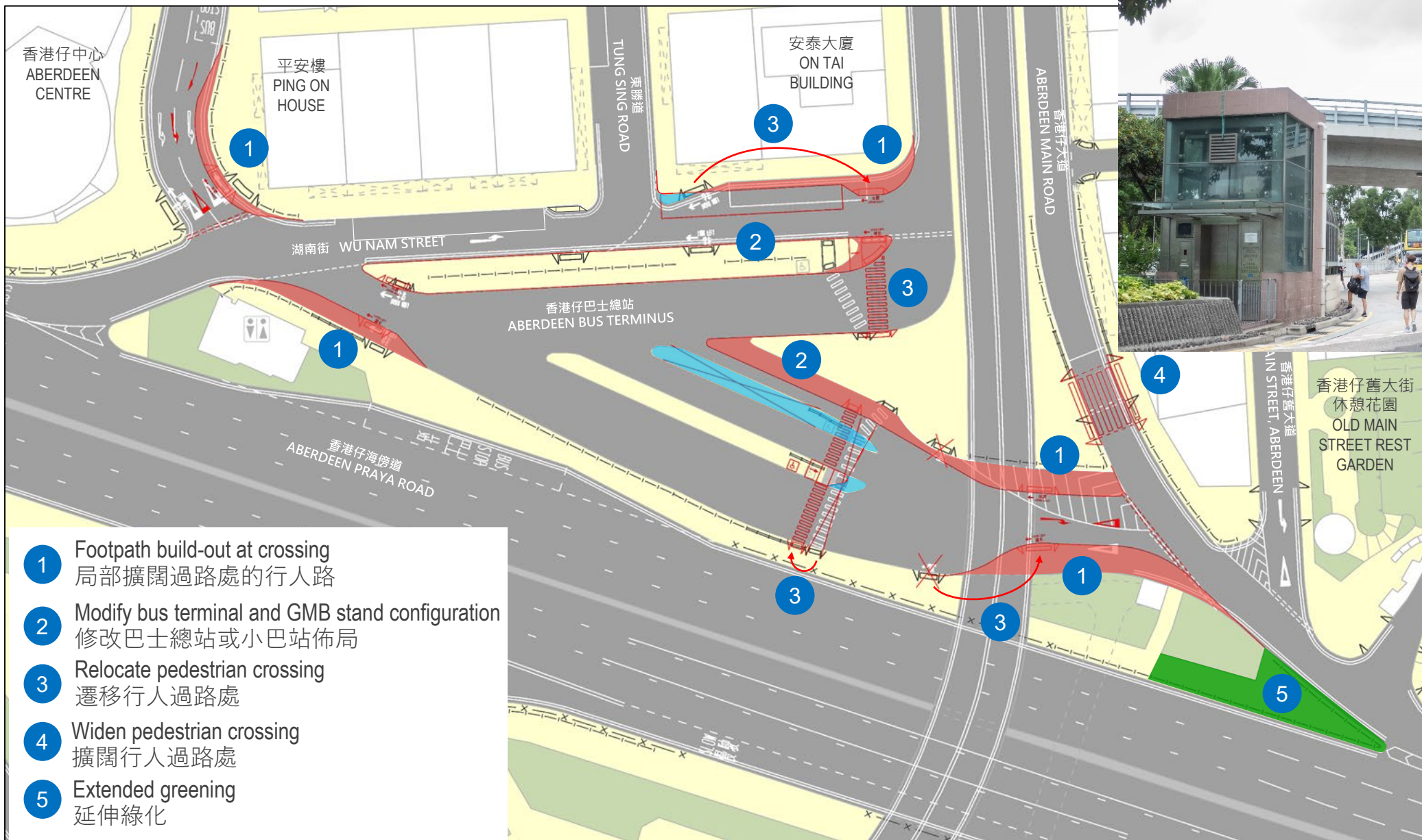

e. Improvement at Kwun Hoi Path 改善觀海徑

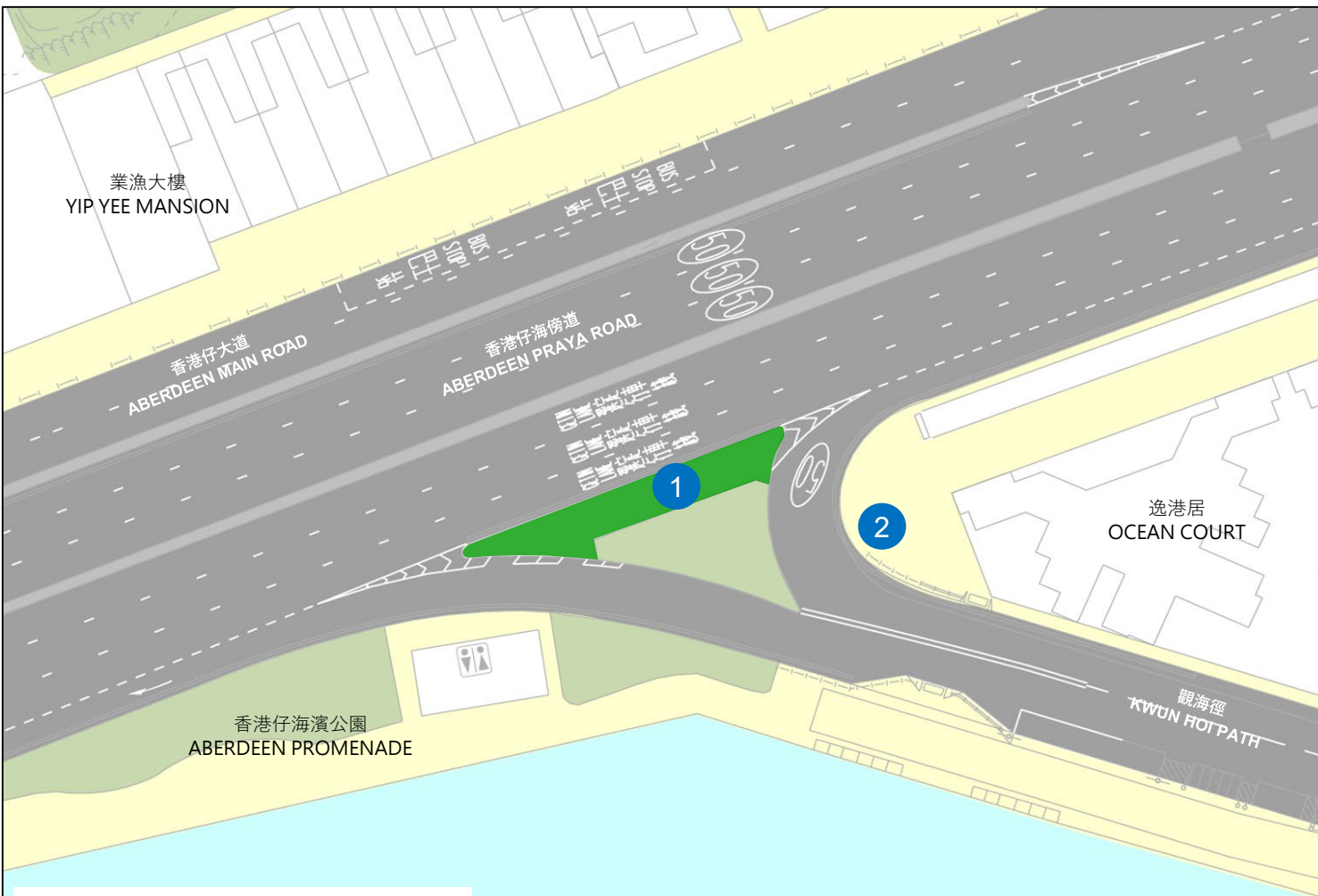

- 1 Extended Greening
擴大綠化範圍
- 2 Provide pedestrian signage
增設行人指示標誌設施



Short-term Proposals 短期方案



- a. Pedestrian Crossings at ALC Bridge**
鴨脷洲大橋的行人過路處
- c. Enhancements to Heung Yip Road, Nam Long Shan Road, Police School Road and Shum Wan Road**
優化香葉道、南朗山道、警校道及深灣道
- d. Footpath Build-outs and Crossing Points at Yip Fat Street**
局部擴闊業發街的行人路及過路處
- e. Additional Pedestrian Crossing at WCH Road**
黃竹坑道增設行人過路處

a. Pedestrian Crossings at ALC Bridge 鴨脷洲大橋的行人過路處

- 1 Relocate pedestrian crossing 遷移行人過路處
- 2 Realign central median 重整中央分隔帶的走線

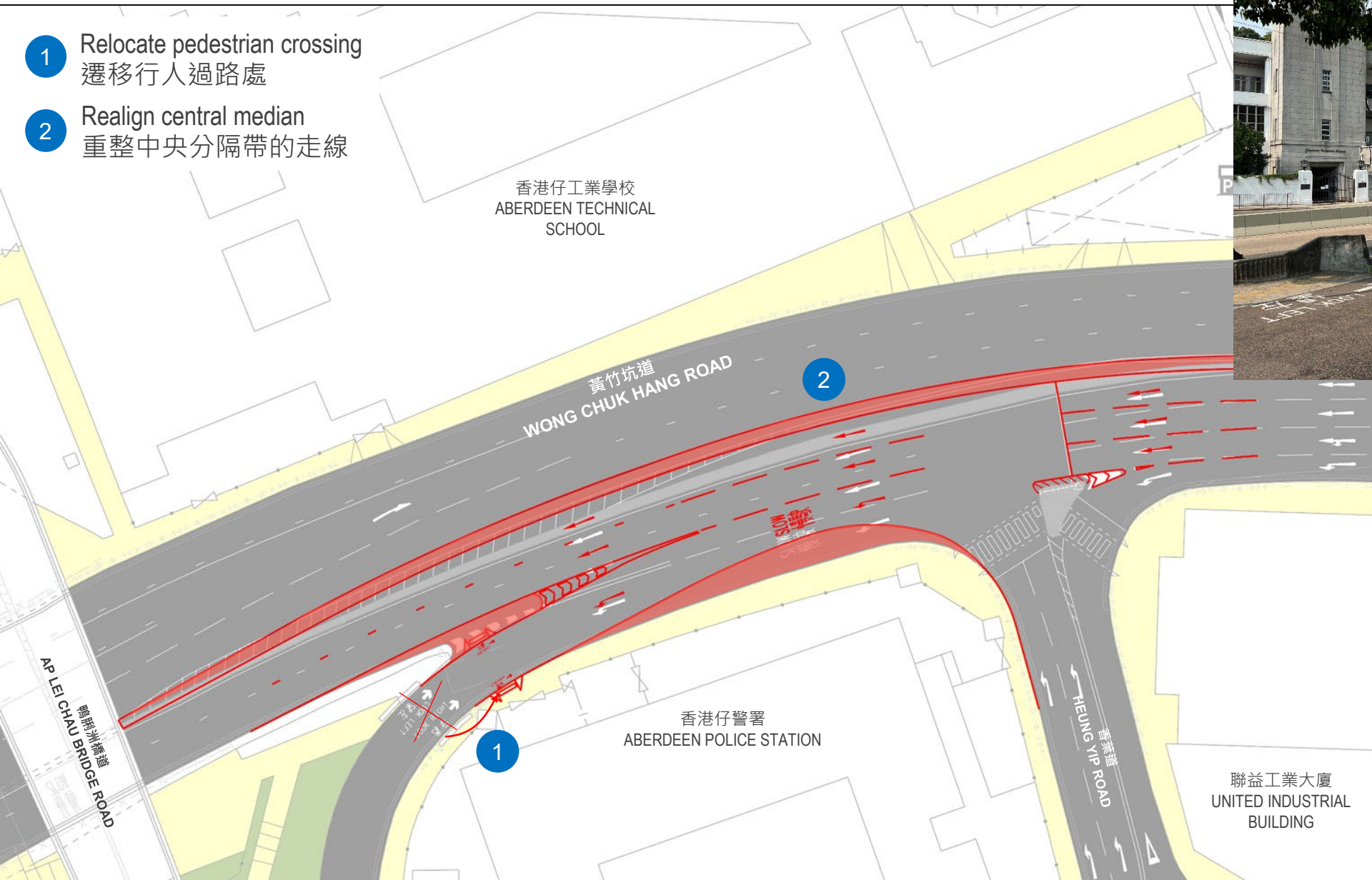

Subject to feasible temporary traffic arrangements in implementation
需視乎施工階段臨時交通安排的可行性

c. Enhancements to Heung Yip Road, Nam Long Shan Road, Police School Road and Shum Wan Road 優化香葉道、南朗山道、警校道及深灣道

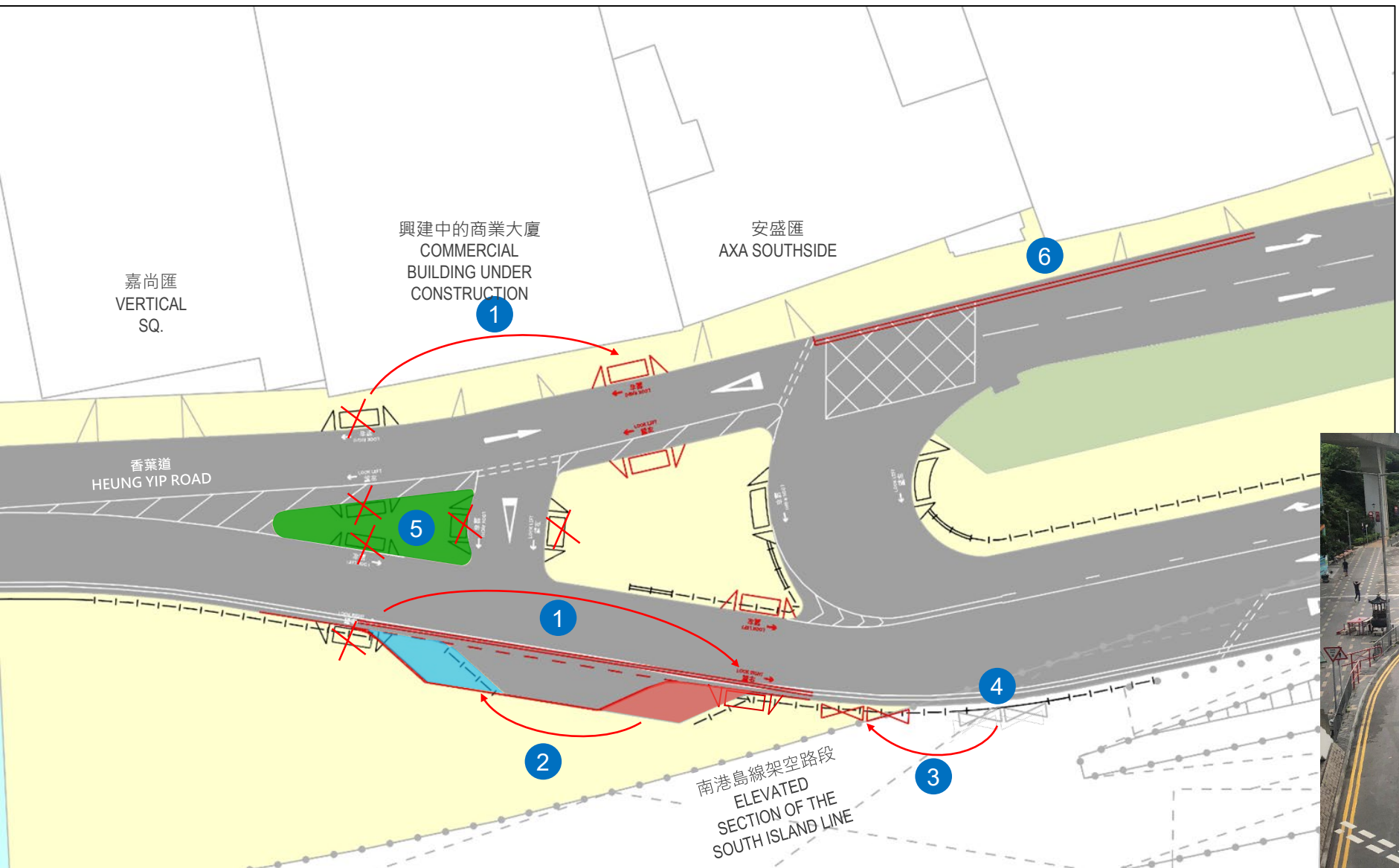

- 1 Relocate pedestrian crossing
遷移行人過路處
- 2 Relocate roadside layby
遷移路旁停車彎
- 3 Relocate crash gate
遷移消防車專用欄
- 4 Fence off existing crash gate location
圍封原消防車專用欄位置
- 5 Add greening
加設綠化
- 6 Proposed double yellow lines
加設雙黃線



c. Enhancements to Heung Yip Road, Nam Long Shan Road, Police School Road and Shum Wan Road 優化香葉道、南朗山道、警校道及深灣道

- 1 Introduce double yellow line
加設雙黃線
- 2 Introduce Taxi pick-up/
drop off point
加設的士上落客處

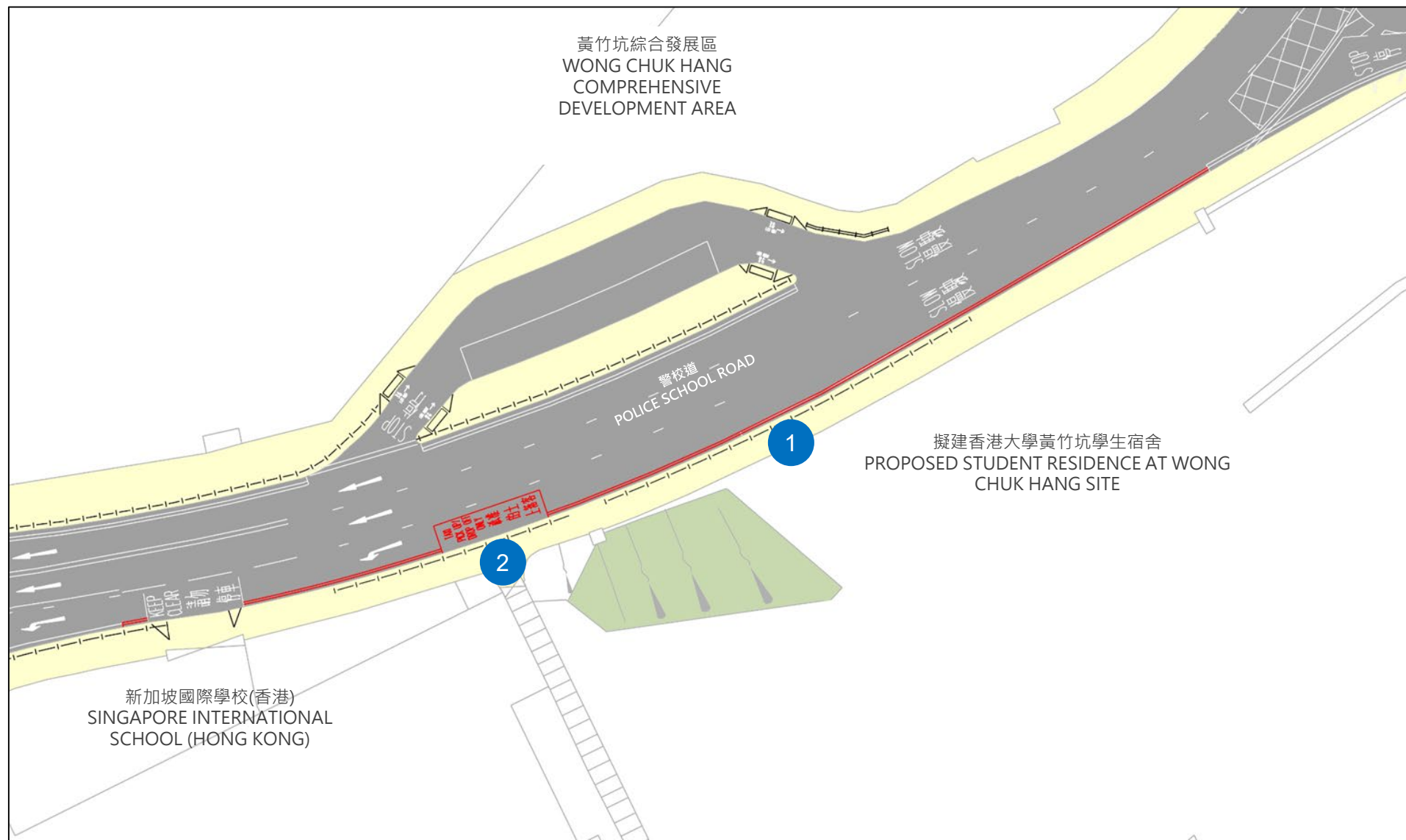

d. Footpath Build-outs & Crossing Points at Yip Fat Street 局部擴闊業發街的行人路及過路處



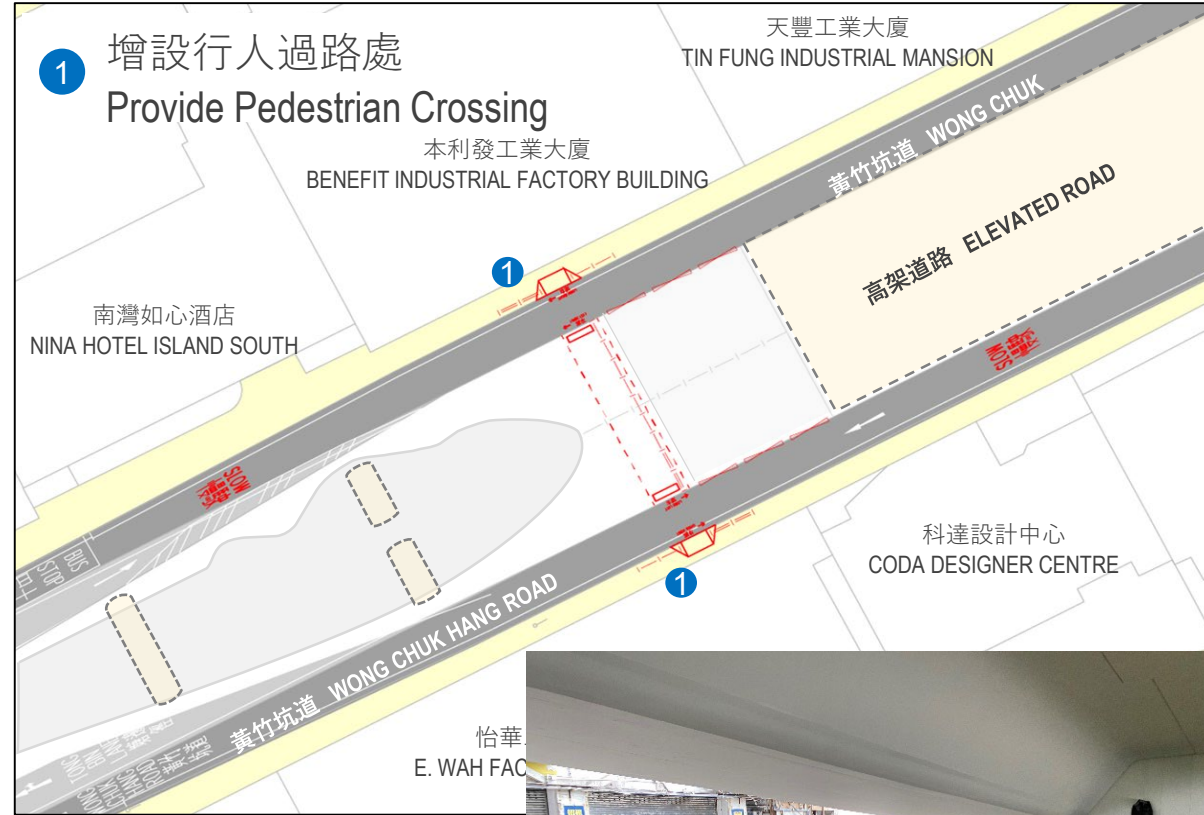

e. Additional Pedestrian Crossing at WCH Road 黃竹坑道增設行人過路處



Medium to Long-term Proposals 中長期方案

圖例 LEGEND

- | | | | |
|--|---|---|---|
|  | 主要行人路
Major Pedestrian Footpath |  | 公共運輸交匯處
Public Transport Interchange |
|  | 現有行人天橋
Existing Footbridge |  | 可能的公眾停車場
Possible Public Vehicle Park |
|  | 連貫的海濱連接
Continuous Waterfront Linkage |  | 登岸設施/碼頭
Landing Facility/Pier |
|  | 活化涌尾明渠
Revitalisation of Staunton Creek Nullah |  | 擬議連接鴨脷洲橋道的升降機
Additional Lift to Ap Lei Chau Bridge Road |
|  | 黃竹坑綠色連線
Green Link in Wong Chuk Hang |  | 現有休憩用地
Existing Open Space |
|  | 提供/優化行人連接
Pedestrian Link Provision/Enhancement |  | 提供/優化休憩用地
Open Space Provision/Enhancement |
|  | 潛在重建項目內可能的行人通道
Possible Pedestrian Passageway within Potential Redevelopment |  | 潛在重建項目用地
Potential Redevelopment Site |
|  | 中長期改善方案
Mid to Long Term Improvement Schemes |  | 景觀走廊
Landscape Corridor |

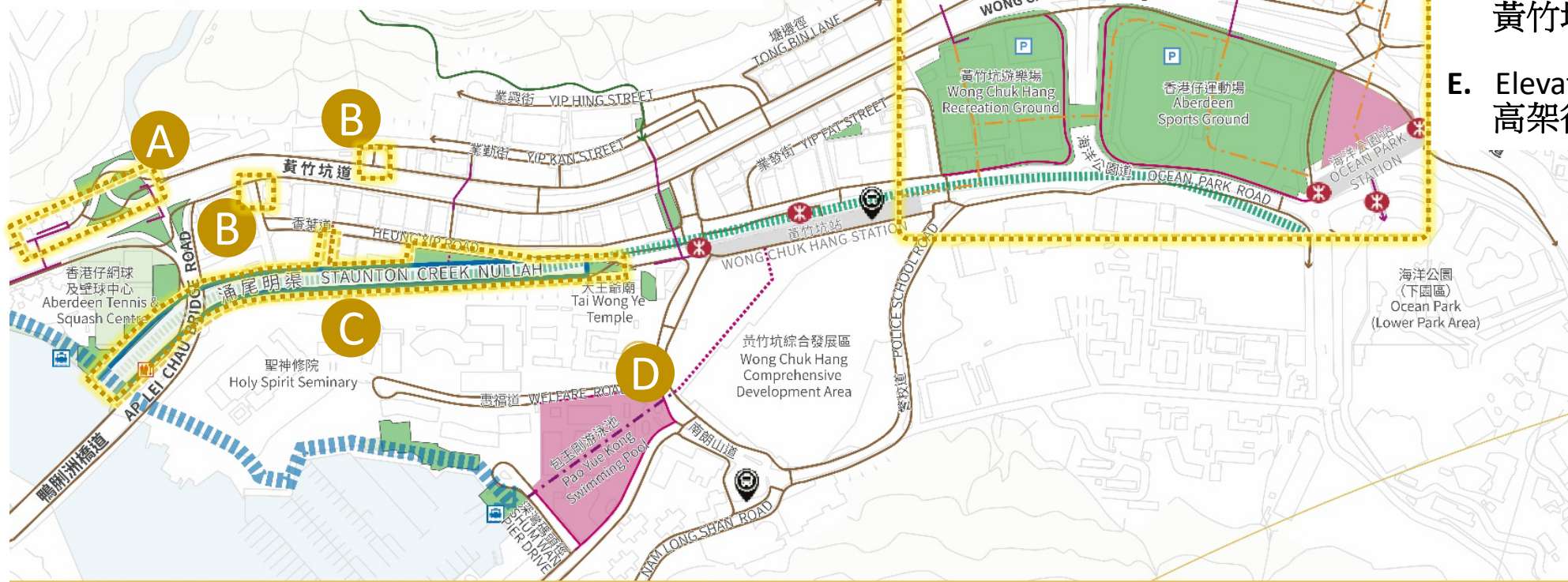

- A.** Enhanced Connectivity at ALC Bridge Road
加強鴨脷洲橋道的連繫性
- B.** Junction Improvements at WCHBA
改善黃竹坑商貿區路口布局
- C.** Connection across Staunton Creek Nullah
橫跨涌尾明渠的连接
- D.** Connection between MTR WCH Station and Sham Wan Waterfront
黃竹坑港鐵站與深灣海濱的连接
- E.** Elevated Walkway System
高架行人通道系統

A. Enhanced Connectivity at ALC Road 加強鴨脷洲橋道的連繫性

- 1 Realign road kerb 重整路緣
- 2 Modify existing staircase 重整現有的樓梯
- 3 Provide lift 增設升降機

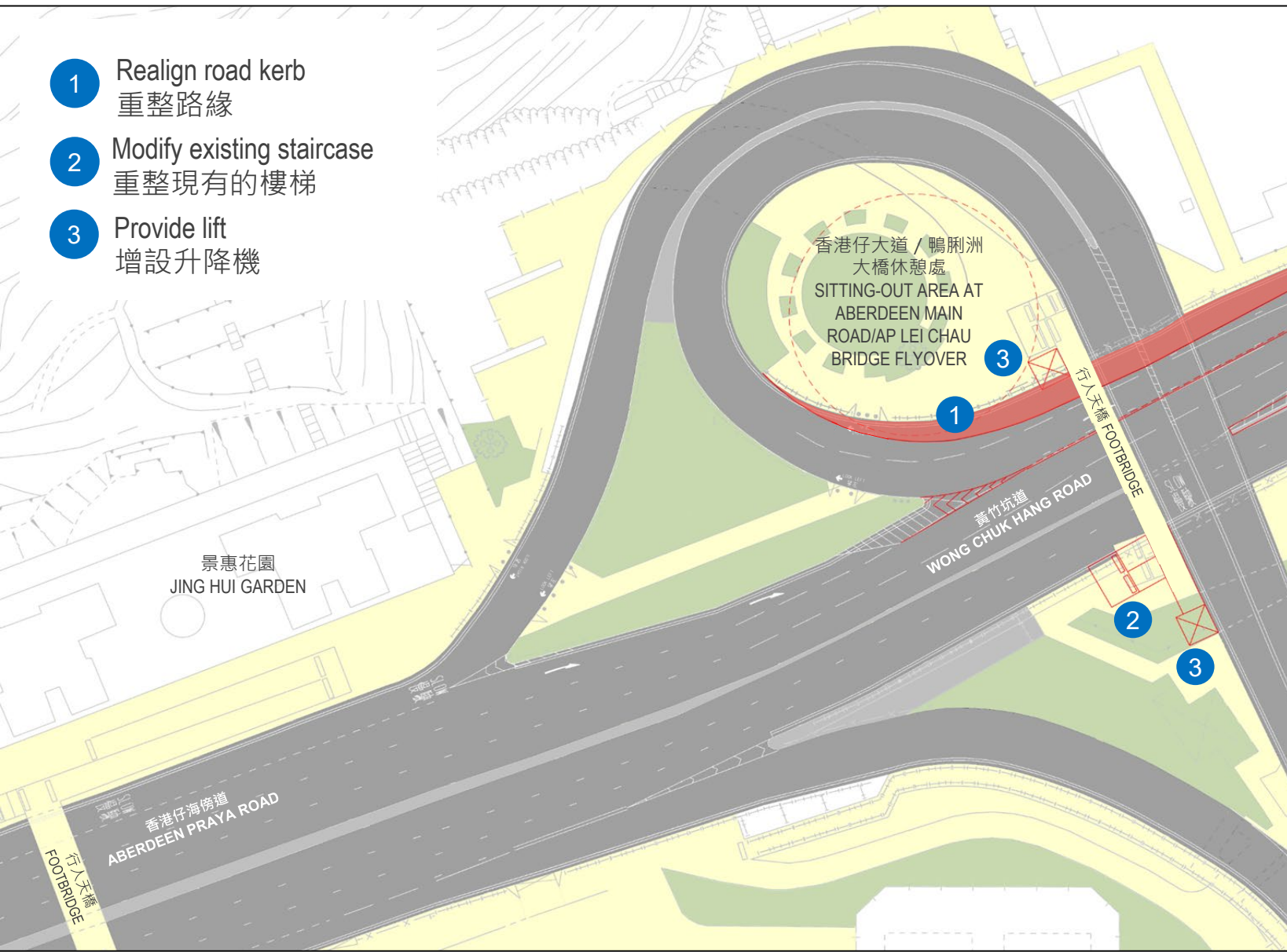

B. Junction Improvements at WCHBA 改善黃竹坑商貿區路口布局

Optimise signal green time
優化綠燈時間



Signalise the junction
改為交通燈控制的路口



C. Connection across Staunton Creek Nullah 橫跨涌尾明渠的連接



Provision of footbridges across the nullah would be explored with a view to transforming the nullah into an appealing and well-connected pedestrian corridor

探討增設橫跨明渠的行人天橋，以期把涌尾明渠打造成為具吸引力及良好連繫的行人走廊

D. Connection between MTR WCH Station & Sham Wan Waterfront 黃竹坑港鐵站與深灣海濱的連接

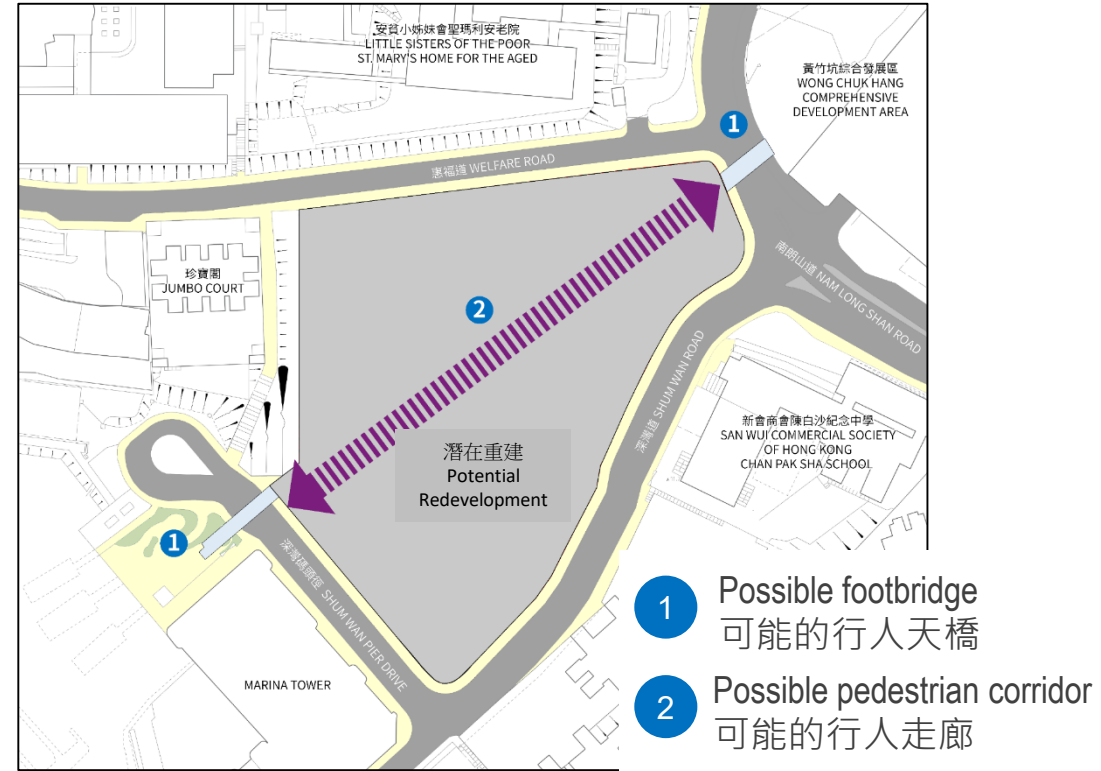

Providing a footbridge connection with the CDA site and through a possible pedestrian corridor for further connection to the Sham Wan waterfront

提供通往黃竹坑綜合發展區的行人天橋，以及可能延伸至深灣海濱的行人走廊

E. Elevated Walkway System (includes an at-grade link) 高架行人通道系統 (包括地面連接)

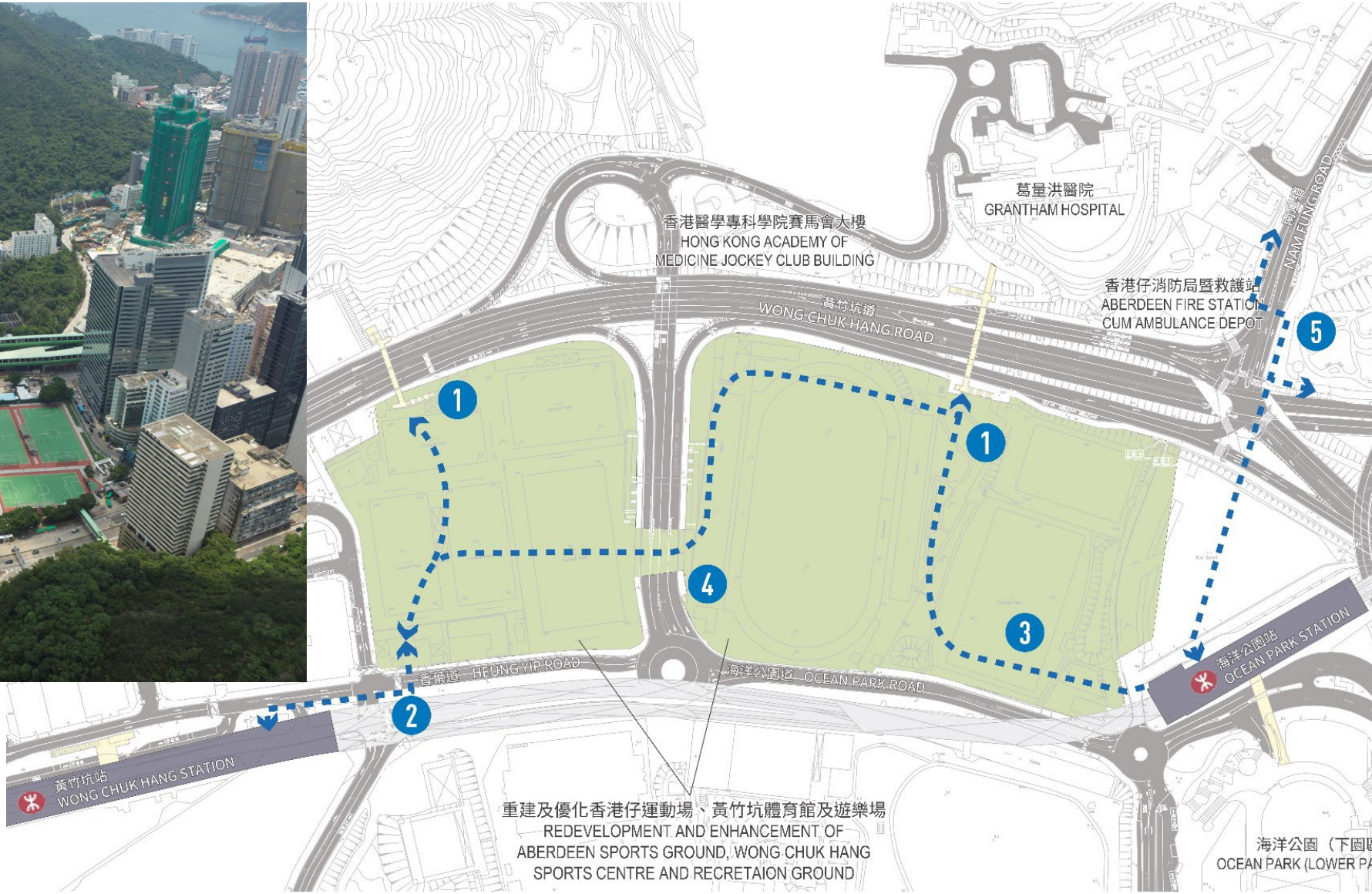

重建及優化香港仔運動場、黃竹坑體育館及遊樂場
REDEVELOPMENT AND ENHANCEMENT OF
ABERDEEN SPORTS GROUND, WONG CHUK HANG
SPORTS CENTRE AND RECREATION GROUND

海洋公園 (下園區)
OCEAN PARK (LOWER PART)

Short-term Proposals 短期方案

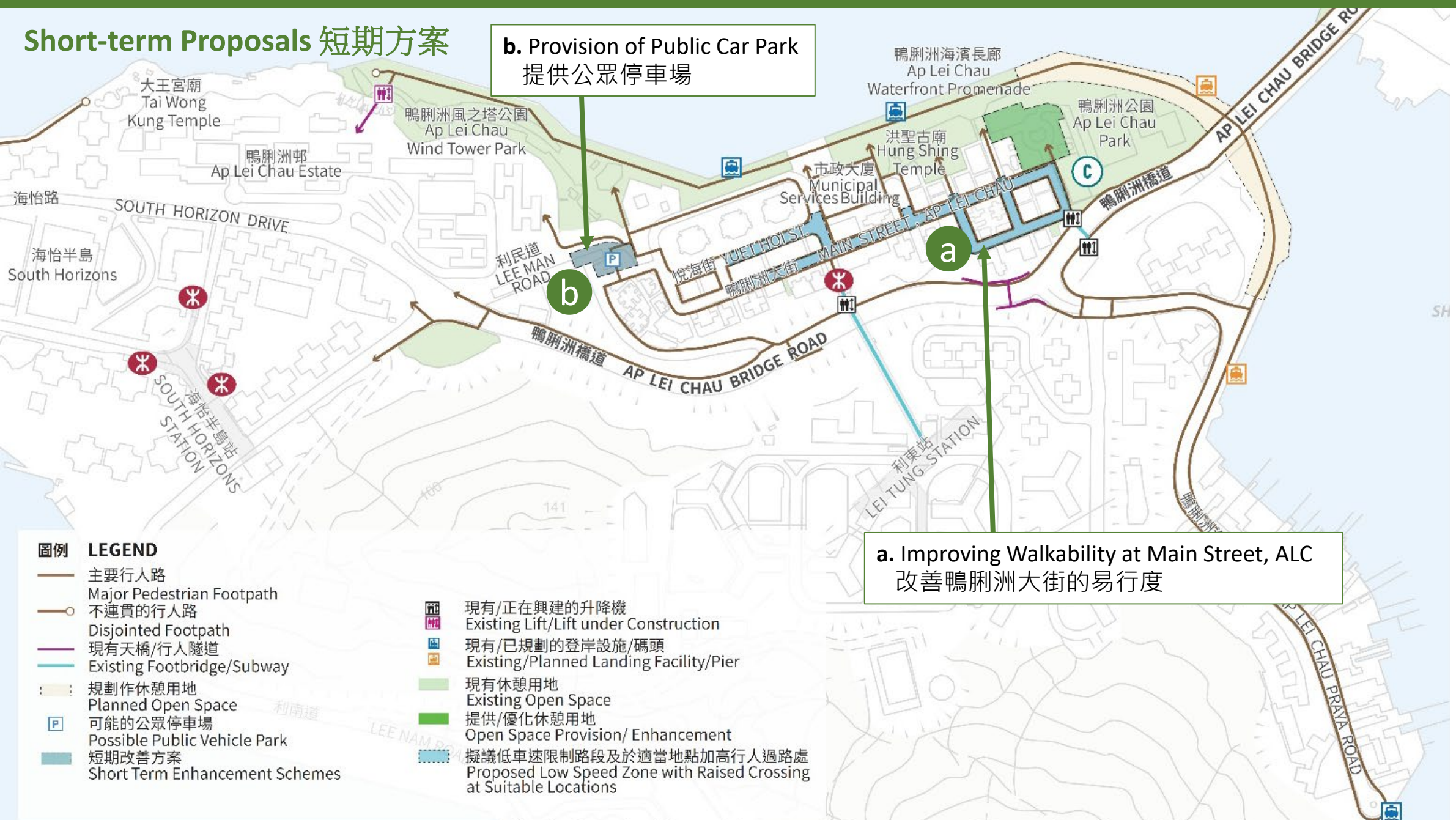

**b. Provision of Public Car Park
提供公眾停車場**

**a. Improving Walkability at Main Street, ALC
改善鴨脷洲大街的易行度**

圖例 LEGEND

- 主要行人路
Major Pedestrian Footpath
- 不連貫的行人路
Disjointed Footpath
- 現有天橋/行人隧道
Existing Footbridge/Subway
- 規劃作休憩用地
Planned Open Space
- 可能的公眾停車場
Possible Public Vehicle Park
- 短期改善方案
Short Term Enhancement Schemes
- 現有/正在興建的升降機
Existing Lift/Lift under Construction
- 現有/已規劃的登岸設施/碼頭
Existing/Planned Landing Facility/Pier
- 現有休憩用地
Existing Open Space
- 提供/優化休憩用地
Open Space Provision/Enhancement
- 擬議低車速限制路段及於適當地點加高行人過路處
Proposed Low Speed Zone with Raised Crossing at Suitable Locations

a. Improving walkability at Main Street, ALC 改善鴨脷洲大街的易行度

- Raised pedestrian crossings on Main Street at the junctions with Hung Shing Street and Ping Lan Street
在大街和洪聖街及平瀾街交界增設行人過路平台、局部擴闊行人路及增設行人過路處
- Footpath build-out on Yuet Hoi Street near Shun Lee Building
在悅海街近順利大廈局部擴闊行人路
- Decluttering of unnecessary railings, bollards and signposts to reclaim space for pedestrians
移除不必要的欄杆、擋柱及路標，騰出更多空間供行人使用
- 30 km/hour low speed zone starting at Yuet Hoi Street and ending on Main Street, after implementation of the above measures and subject to speed survey
在實施以上措施後及視乎車速調查，在悅海街至鴨脷洲大街試行每小時30 公里的低速限制區



b. Provision of Public Car Park 提供公眾停車場

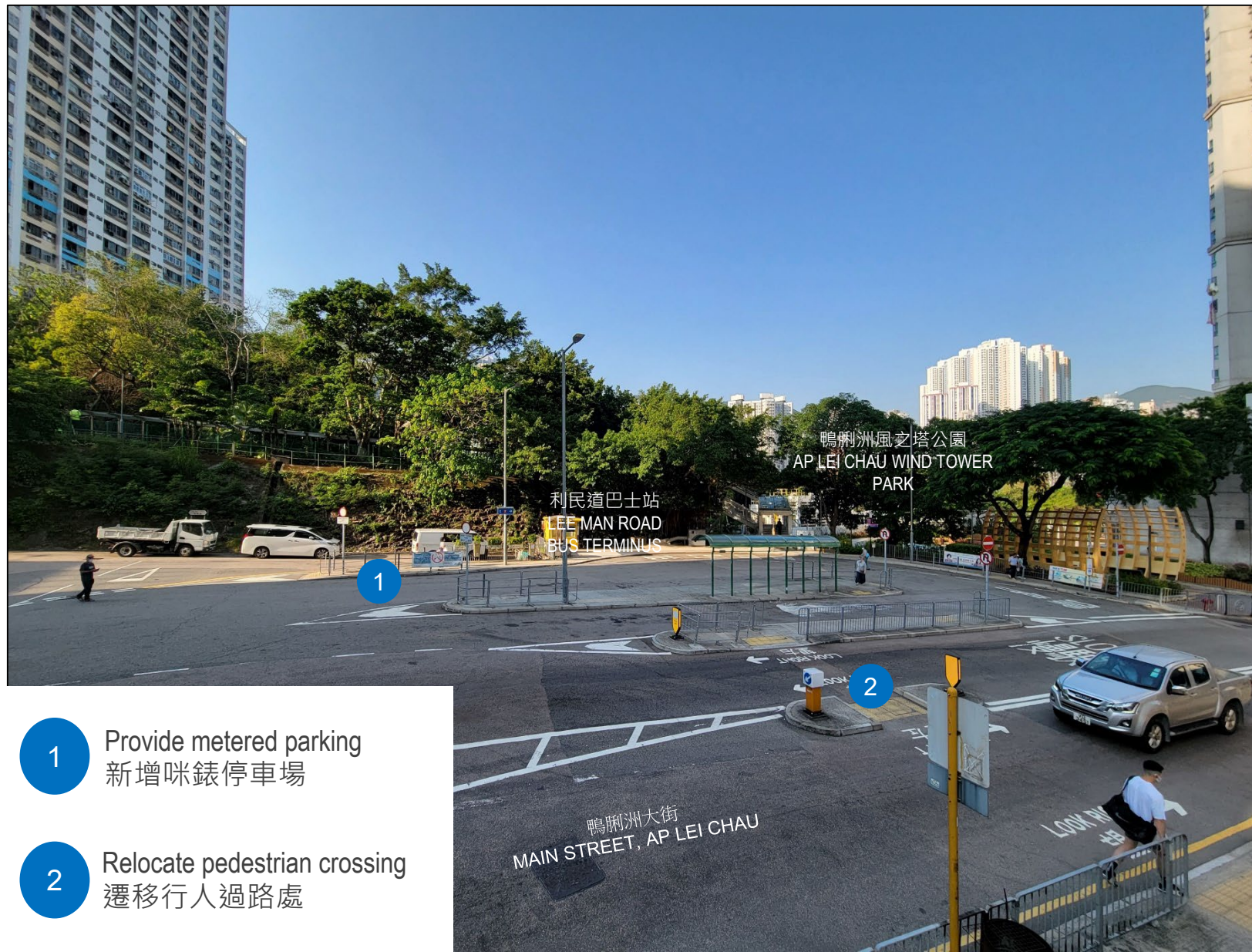

1

Provide metered parking
新增咪錶停車場

2

Relocate pedestrian crossing
遷移行人過路處

Medium to Long-term Proposals 中長期方案



A. Pedestrian connection between ALC Wind Tower Park & South Horizons
 鴨脷洲風之塔公園及海怡半島之間的行人連接

B. Traffic improvement measures in the Main Street Area
 鴨脷洲大街一帶的交通改善措施

A. Pedestrian connection between ALC Wind Tower Park & South Horizons

鴨脷洲風之塔公園及海怡半島之間的行人連接

- A possible walkway to connect ALC Wind Tower Park, Tai Wong Kung Temple and South Horizons
連接鴨脷洲風之塔公園、大王宮廟和海怡半島海濱的可能海濱步道
- Having regard to the egrets resting on the hillside, improvement works would be of a minimal scale.
Greening would be enhanced to enrich biodiversity

考慮到有白鷺群棲息在山坡上，改善工程將會以小規模進行；提升綠化促進生物多樣性

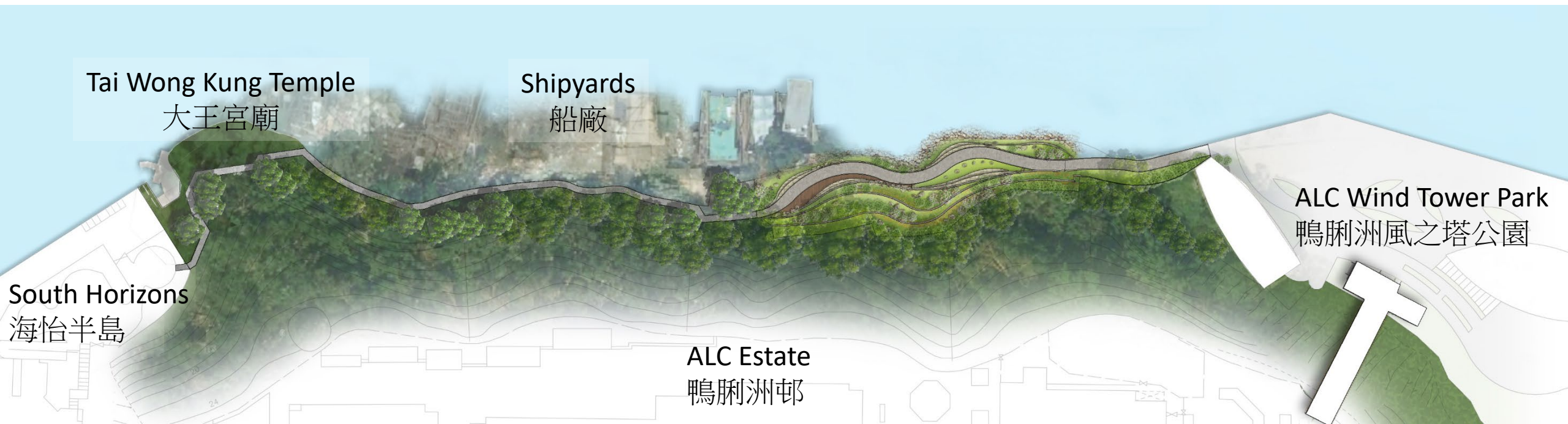

B. Traffic improvement measures in the Main Street Area 鴨脷洲大街一帶的交通改善措施

- 1 Provide new road
加設新行車路
- 2 Provide raised pedestrian crossing
設置行人過路平台
- 3 Modify to raised signalised pedestrian crossing
改為燈控行人過路平台
- 4 Provide pedestrian crossing
加設行人過路處
- 5 Provide build-out
擴闊過路處的行人路
- 6 Start/end of low speed zone
開始/完結低速行車限制區

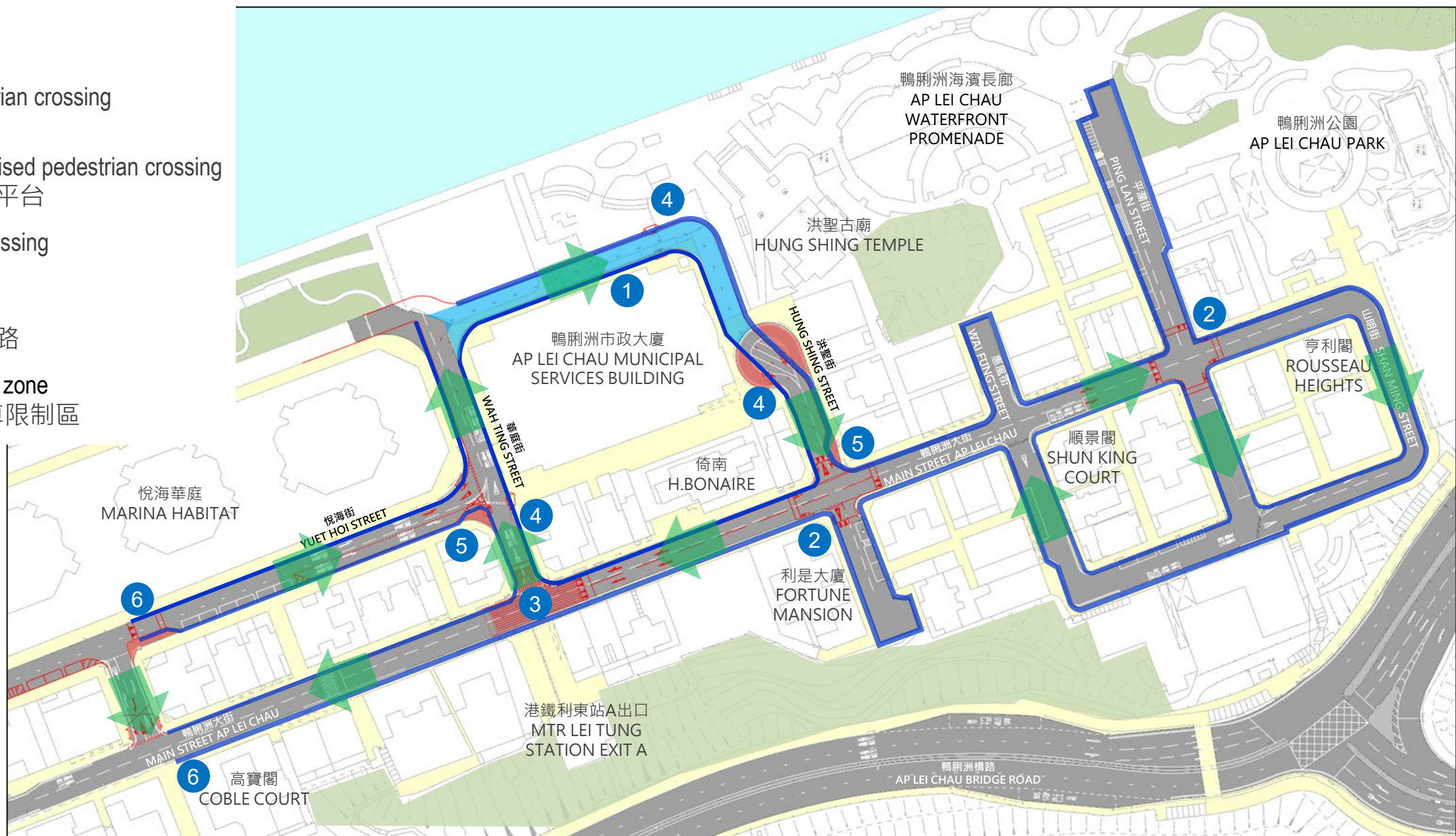

B. Traffic improvement measures in the Main Street Area 鴨脷洲大街的交通改善措施

- Making use of the existing 7-a-side football pitch site at ALC Park to provide a public vehicle park (possibly at ground level) with reprovision of football pitch above
利用鴨脷洲公園的七人足球場用地，提供公共停車場（可能位於地面）及重置足球場於其上
- Part of the parking provision would replace the existing metered parking spaces in the area to improve the pedestrian environment
部分提供的車位將取代區內現有咪錶泊車位，以改善行人環境



Short-term Proposals 短期方案

- a. Sham Wan Waterfront and Proposed Boardwalk
深灣海濱及建議行人板道
- b. Shum Wan Pier Drive
深灣碼頭徑
- c. Footpath widening along Sham Wan Road
擴闊深灣道的行人路

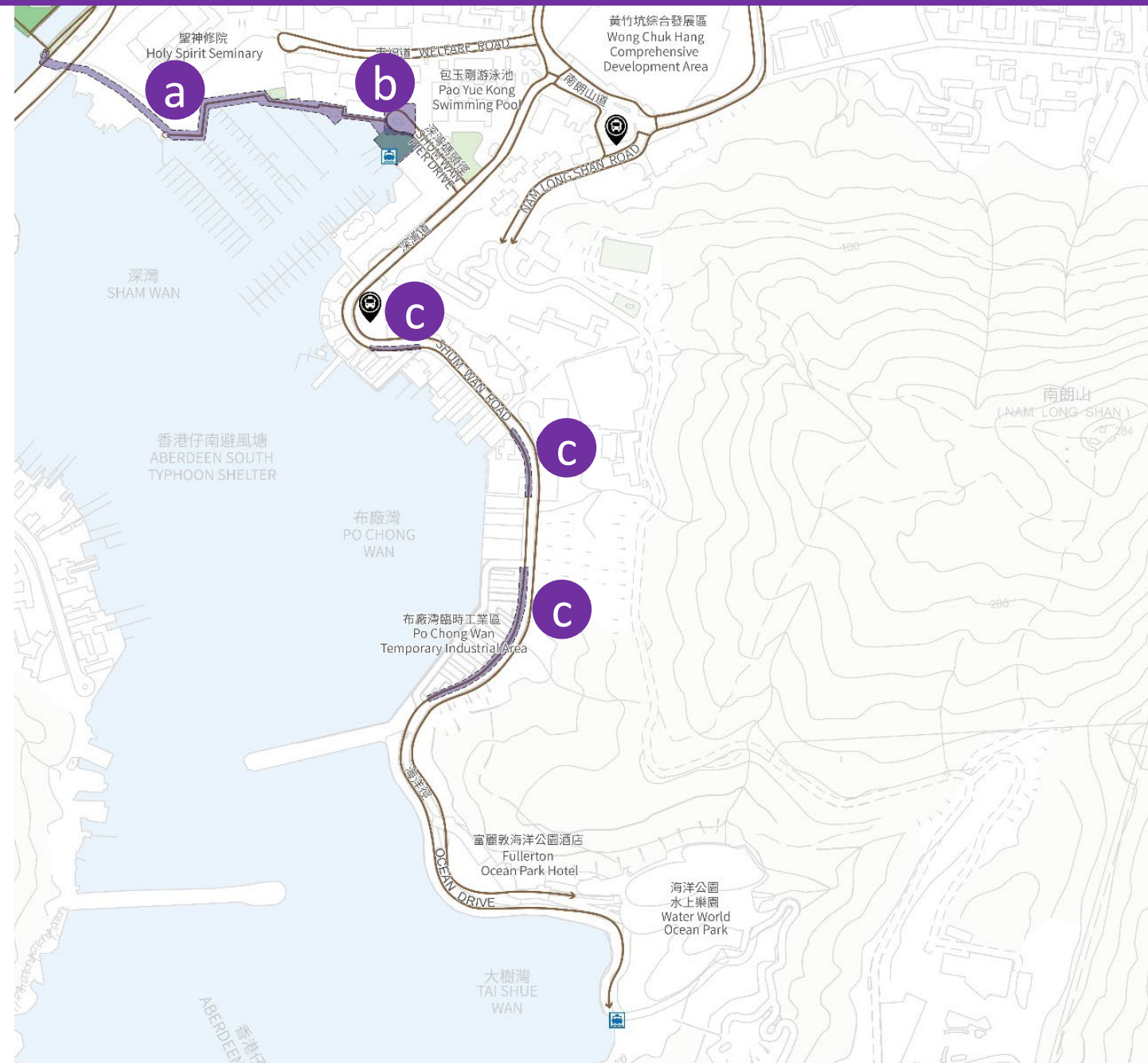

a. Sham Wan Waterfront and Proposed Boardwalk 深灣海濱及建議行人板道

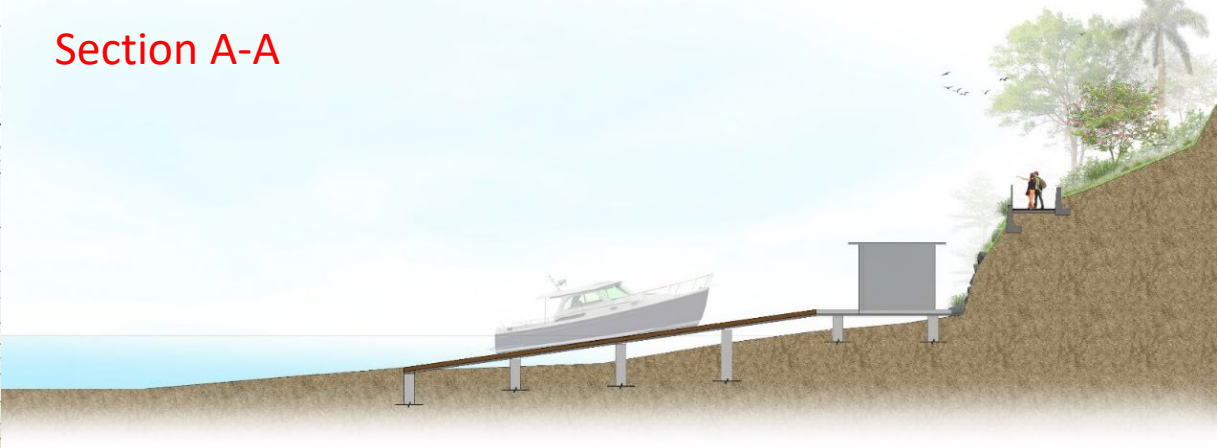
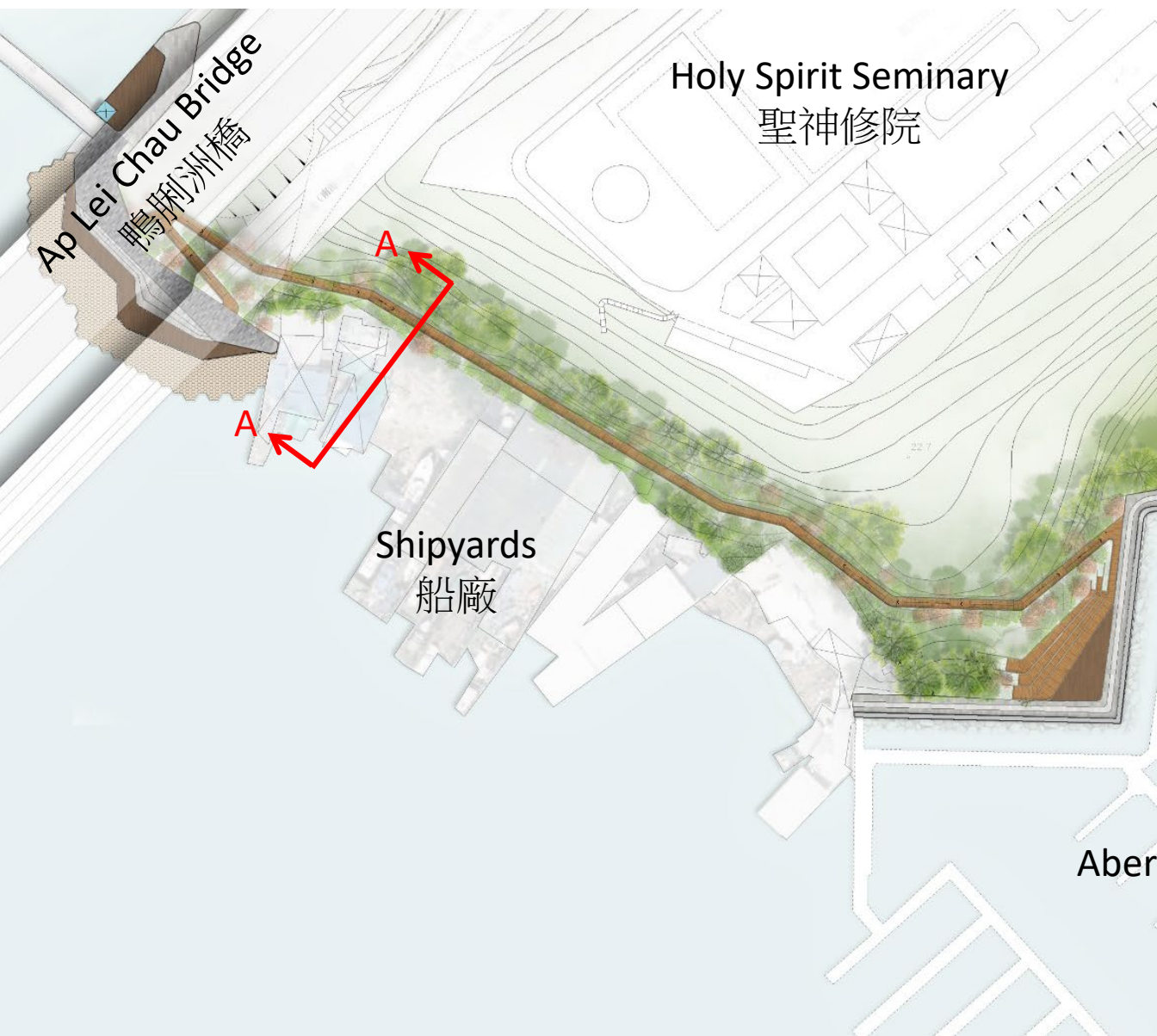

b. Shum Wan Pier Drive 深灣碼頭徑



- 1 修改調頭處以配合行人路擴闊
Modify cul-de-sac for footpath widening
- 2 重置不整路緣
Realign kerb lines
- 3 重整調頭處空間以免違泊
Realign cul-de-sac to deter illegal parking
- 4 加設指定上/落客貨區
Designate layby for pick-up/drop off and loading/unloading

c. Footpath widening along Sham Wan Road 擴闊深灣道的行人路



1 擴闊現有行人路
Widen existing footpath



2 擴闊現有行人路
Widen existing footpath



3 擴闊現有行人路
Widen existing footpath

Medium to Long-term Proposals 中長期方案

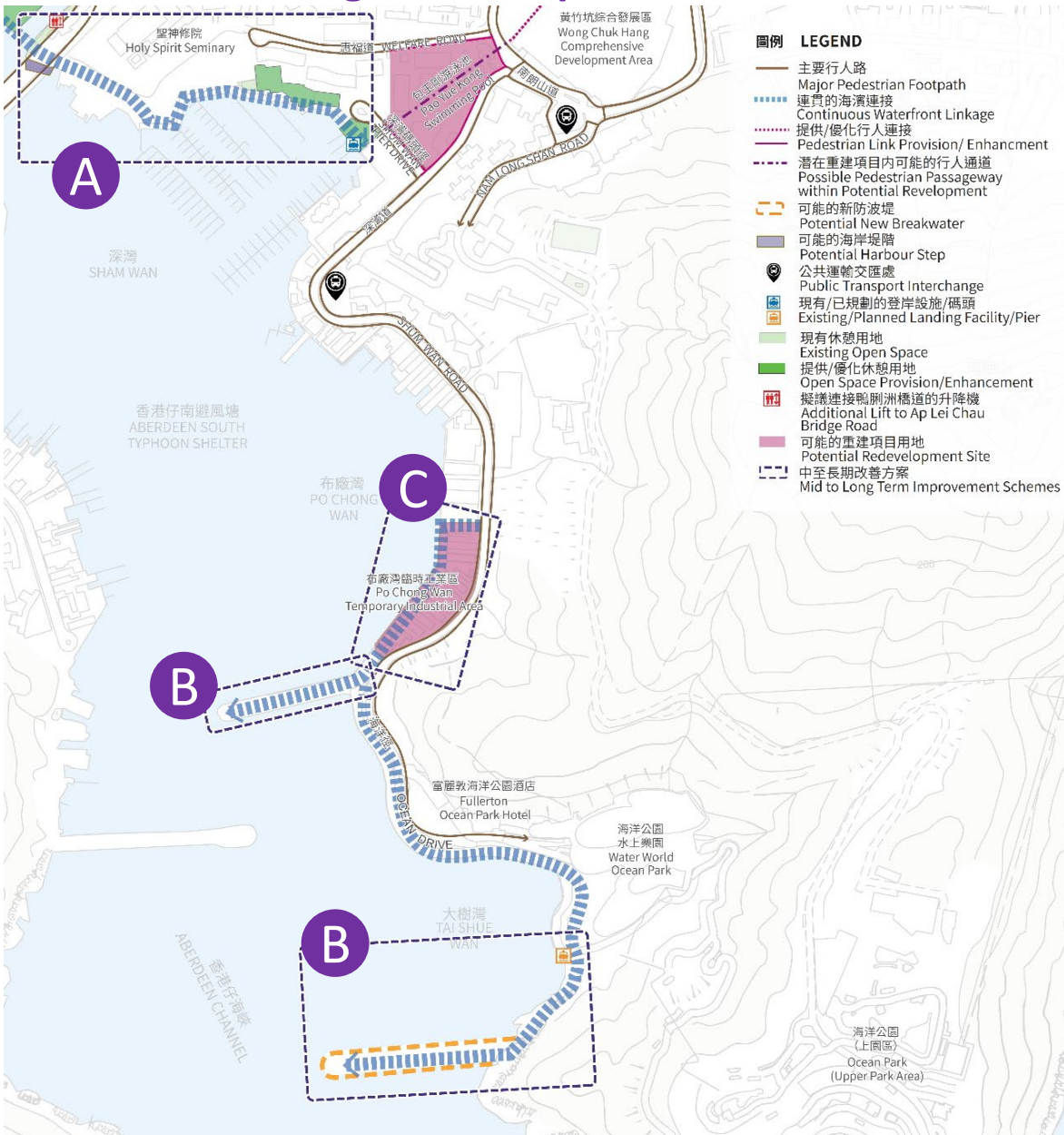

A. Sham Wan Waterfront and Connection with ALC 深灣海濱及與鴨脷洲的连接

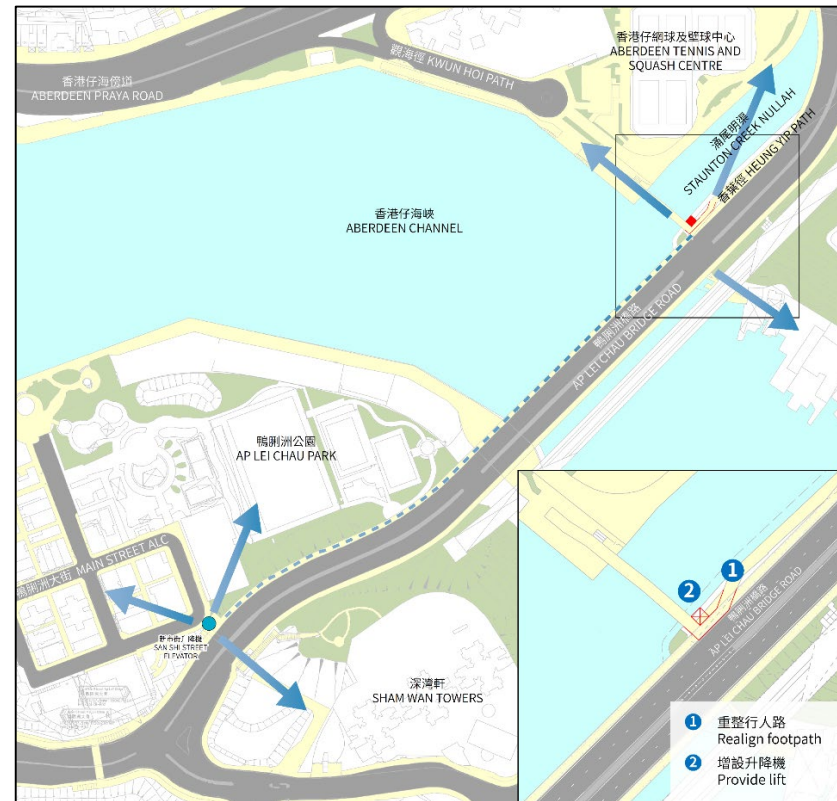

B. Opening up the Breakwaters at Aberdeen Typhoon Shelter 開放香港仔避風塘防波堤

C. Continuous Waterfront along Po Chong Wan 連貫的布廠灣海濱

Open Space Enhancement and Provision Proposals

優化及提供休憩空間的建議

Short-term Proposals 短期方案

圖例 LEGEND

-  主要行人路
Major Pedestrian Footpath
-  現有天橋/行人隧道
Existing Footbridge/Subway
-  提供行人連接
Pedestrian Link Provision

-  公共運輸交匯處
Public Transport Interchange
-  登岸設施/碼頭
Landing Facility/Pier
-  現有休憩用地
Existing Open Space
-  短期改善方案
Short Term Enhancement Schemes

a. Enhancement of Tin Wan Waterfront Area
優化田灣海濱

b. Facelifting of Aberdeen Praya Road SoA
美化香港仔海傍道休憩處



香港仔西避風塘
ABERDEEN WEST
TYPHOON SHELTER

石排灣
SHEK PAI WAN

觀海徑
KWUN
HOI PATH

a. Enhancement of Tin Wan Waterfront 優化田灣海濱



b. Facelifting of Aberdeen Praya Road SoA 美化香港仔海傍道休憩處



- Remove the existing fences and gates
拆除柵欄和閘門
- Upgrade paving, seating platform and shelter
美化地磚、座椅及遮蔭設施
- Facelifting treatment on the ramp structure
美化斜面行人道

Medium-term Proposals 中期方案



A. Revitalisation of Aberdeen Wholesale Fish Market 活化香港仔魚類批發市場



Promote the sale of local fisheries produce at both wholesale and retail levels through the revitalisation of the Fish Market, incorporating F&B, viewing deck and other elements to create a vibrant waterfront.

透過活化魚市場計劃，促進本地漁產品在批發及零售層面的銷售，加入餐飲、觀景台和其他元素，締造活力海濱。

B. Enhancement of Aberdeen Promenade 優化香港仔海濱



Short-term Proposals 短期方案

香港仔郊野公園
Aberdeen Country Park



- a.** SoA at Aberdeen Main Road & ALC Bridge (North) Children Playground
香港仔大道休憩處及鴨脷洲大橋（北）兒童遊樂場
- b.** Improvement of Open Spaces
Adjacent to Staunton Creek Nullah
改善毗鄰涌尾明渠的公共空間

a. SoA at Aberdeen Main Road and ALC Bridge (North) Children Playground 香港仔大道休憩處及鴨脷洲大橋（北）兒童遊樂場



b. Improvement of Open Spaces Adjacent to Staunton Creek Nullah 改善毗鄰涌尾明渠的公共空間

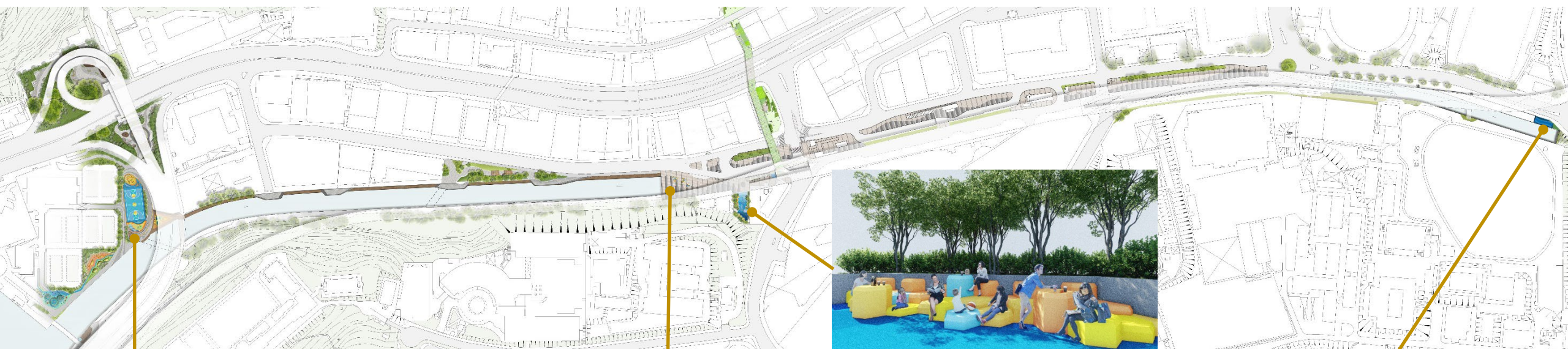

Short-term Proposals 短期方案



c. Transformation & Extension of Children's Playground in ALC Park
 改造及擴建鴨脷洲公園兒童遊樂場

圖例 LEGEND

- | | | | |
|--|--------------------------------|--|--|
| | 主要行人路 | | 現有/正在興建的升降機 |
| | Major Pedestrian Footpath | | Existing Lift/Lift under Construction |
| | 不連貫的行人路 | | 現有/已規劃的登岸設施/碼頭 |
| | Disjointed Footpath | | Existing/Planned Landing Facility/Pier |
| | 現有天橋/行人隧道 | | 現有休憩用地 |
| | Existing Footbridge/Subway | | Existing Open Space |
| | 規劃作休憩用地 | | 提供/優化休憩用地 |
| | Planned Open Space | | Open Space Provision/ Enhancement |
| | 可能的公眾停車場 | | 擬議低車速限制路段及於適當地點加高行人過路處 |
| | Possible Public Vehicle Park | | Proposed Low Speed Zone with Raised Crossing at Suitable Locations |
| | 短期改善方案 | | |
| | Short Term Enhancement Schemes | | |

c. Transformation & Extension of Children's Playground in ALC Park 改造及擴建鴨脷洲公園兒童遊樂場

The existing children's playground and its adjoining area in ALC Park will be transformed into more attractive, user-inclusive, challenging and fun to play public play space. It is undergoing a design competition to collect innovative design ideas, concepts and proposals.

鴨脷洲公園內的現有兒童遊樂場和其毗鄰空間將會改造成更具吸引力、包容、具挑戰性和有趣的遊樂空間。現正透過設計比賽徵集創新的設計構思、概念和方案。



Medium to Long-term Proposals 中至長期方案

“Pets”
「寵」

“Heritage”
「遺」



C Open Space Enhancements & Provision
優化及提供公共空間



D Exercise, Viewing Deck, F&B & Dragon Boat Storage 運動、觀景台、餐飲及龍舟存放



Short-term Proposals 短期方案



Footpath Widening along Sham Wan Road 擴闊深灣道的行人路



Sham Wan Waterfront and Proposed Boardwalk 深灣海濱及建議行人板道

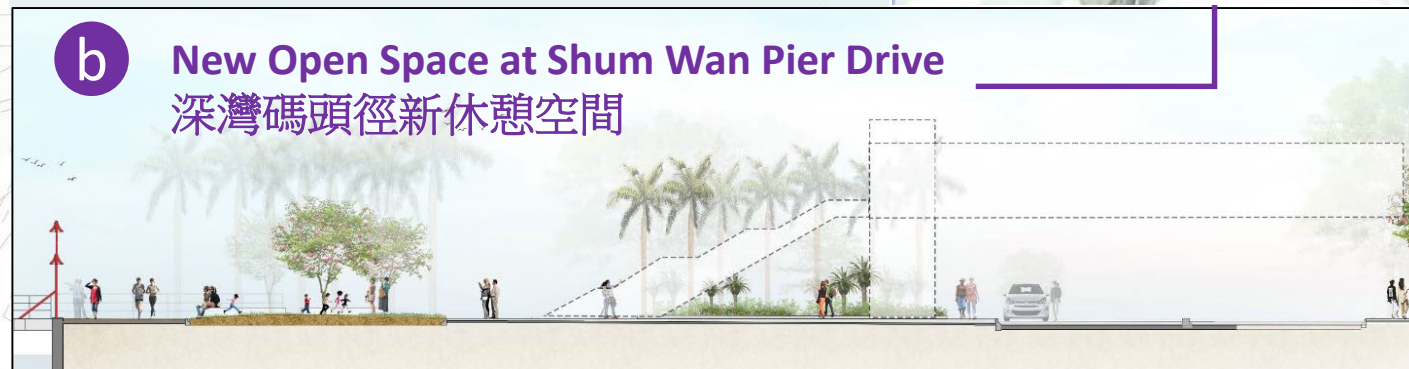

New Open Space at Shum Wan Pier Drive 深灣碼頭徑新休憩空間

Medium to Long-term Proposals 中長期方案

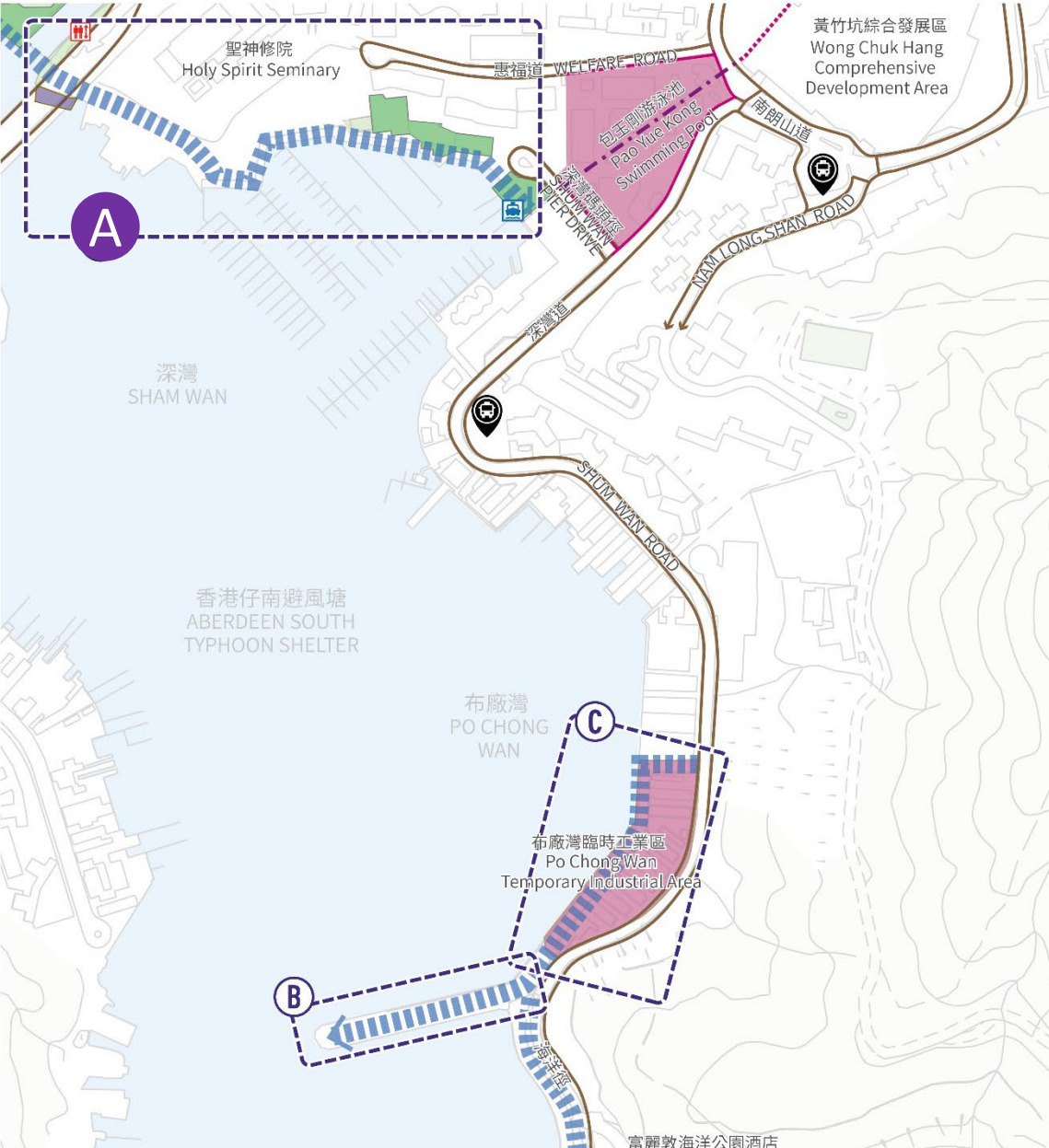

Harbour Steps 海濱階梯

- B** Opening Up the Breakwaters at Aberdeen Typhoon Shelter 開放香港仔避風塘防波堤
- C** Continuous Waterfront along Po Chong Wan 連貫的布廠灣海濱

田灣及香港仔海濱長廊
TIN WAN AND ABERDEEN PROMENADE

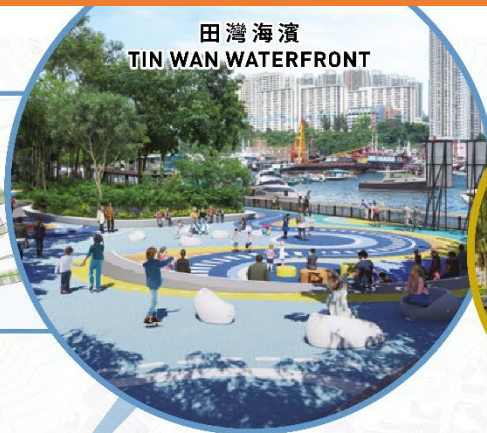

涌尾明渠園境走廊
STAUNTON CREEK NULLAH LANDSCAPE CORRIDOR



深灣步道
SHAM WAN WALKWAY



鴨脷洲海濱長廊
AP LEI CHAU PROMENADE



圖例 LEGEND

-  主要園境走廊
Key Landscape Corridor
-  研究範圍
Study Area

Your views 你的意見

- E-form 電子表格
- Email 電郵
- Post 郵寄
- **Public Forum 公眾論壇**
3/12/2022
14:30 – 16:30
Ap Lei Chau Community Hall 鴨脷洲社區會堂



- **Roving Exhibition 巡迴展覽**

Open Space next to Tai Wong Ye Temple, Wong Chuk Hang
黃竹坑大王爺廟旁公共空間
19/11 – 2/12

Public Space near MTR Lei Tung Station Exit A1
港鐵利東站A1出口旁公共空間
20 – 25/11 & 3 – 9/12

Exhibition House at the Aberdeen Promenade
香港仔海濱公園展覽小屋
26/11 – 9/12